

# GOOGLE ADMIN CHROME EXTENSION MANAGEMENT

Enable users to view and access content from Gale's *Opposing Viewpoints In Context* within Google results. Follow the steps below to install the chrome extension (beta) to shared computers sharing settings via the Google Admin Tool.

**STEP ONE:** Login to your Google admin account via <http://admin.google.com>

**STEP TWO:** In the Admin console, select **Device Management**

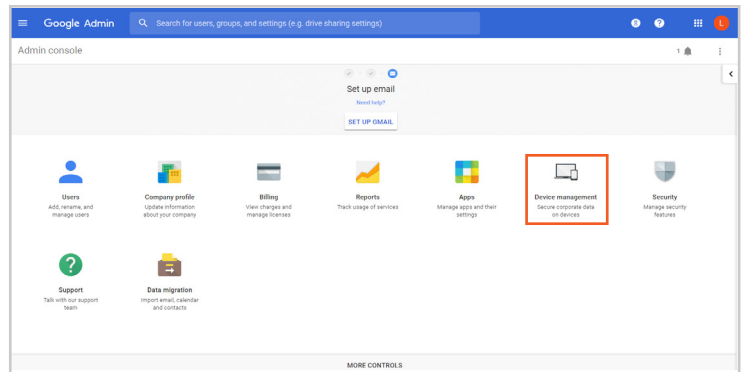

**STEP THREE:** Select **Chrome Management**

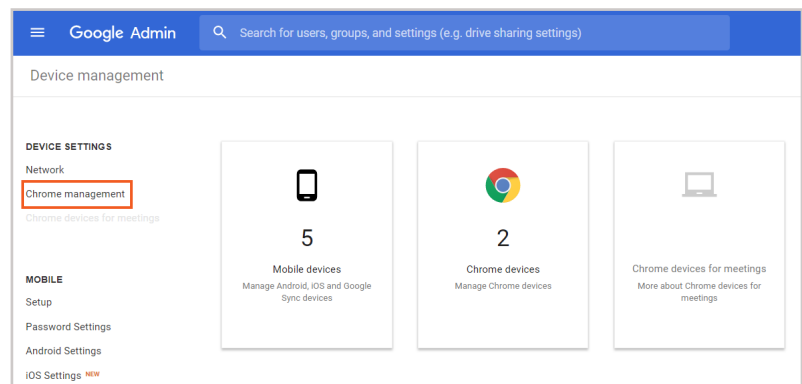

**STEP FOUR:** Select **User Settings**

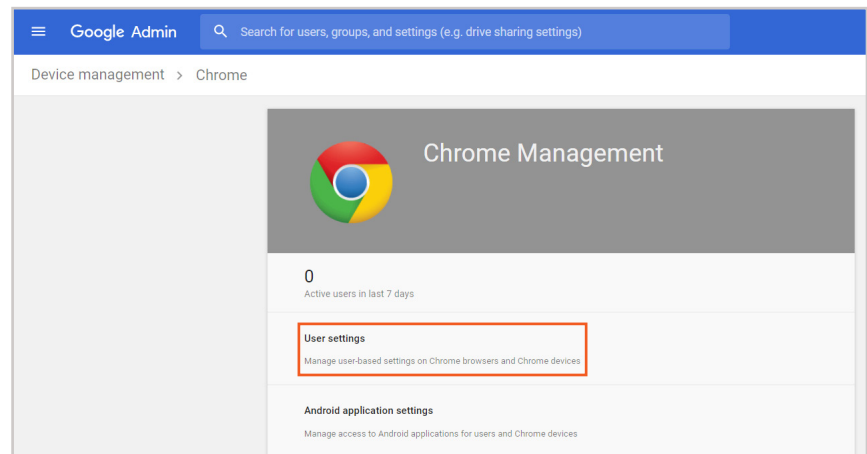

**STEP FIVE:** Under Apps and Extensions section > **Force-installed Apps and Extensions**, select the **Managed force-installed apps** link

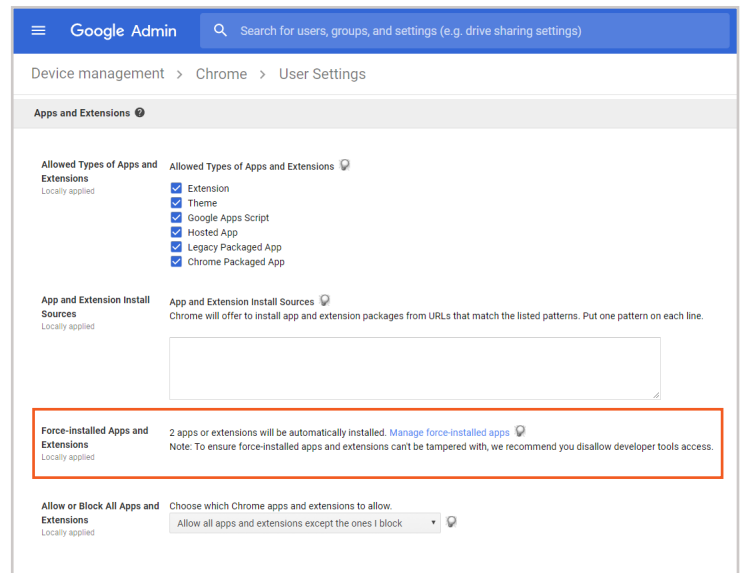

**STEP SIX:** Select **Specifying a Custom App**

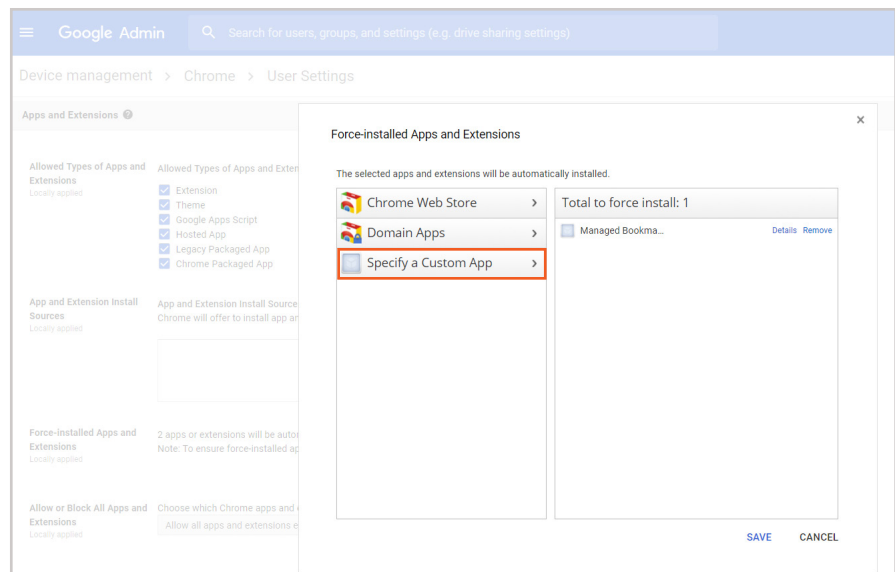

**STEP SEVEN:** Fill in the following fields to add *Opposing Viewpoints In Context* (Beta)

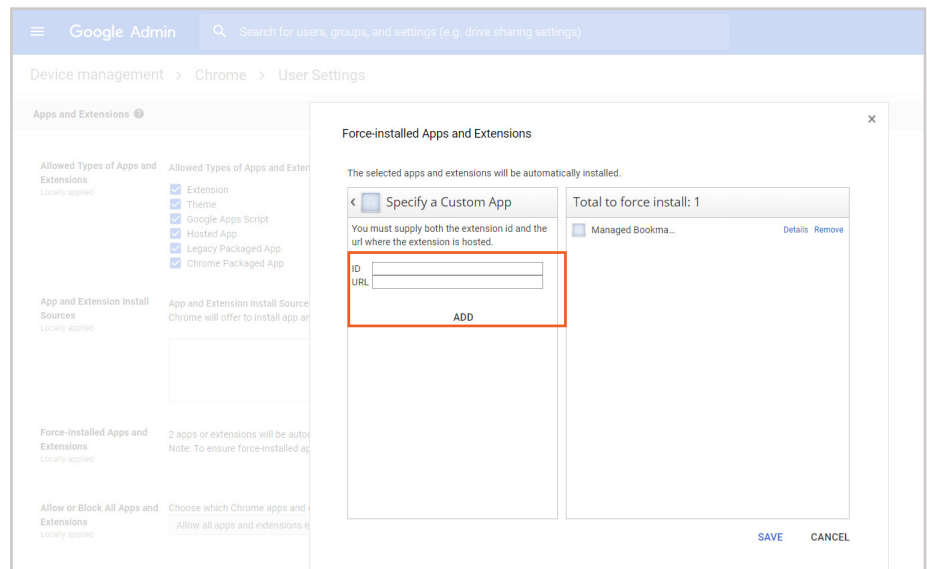

## INSTALLATION GUIDE | OPPOSING VIEWPOINTS IN CONTEXT

ID = ccegamhhibcodocaecdilkifoefhljkh

URL = <https://chrome.google.com/webstore/detail/opposing-viewpoints-in-co/ccegamhhibcodocaecdilkifoefhljkh>

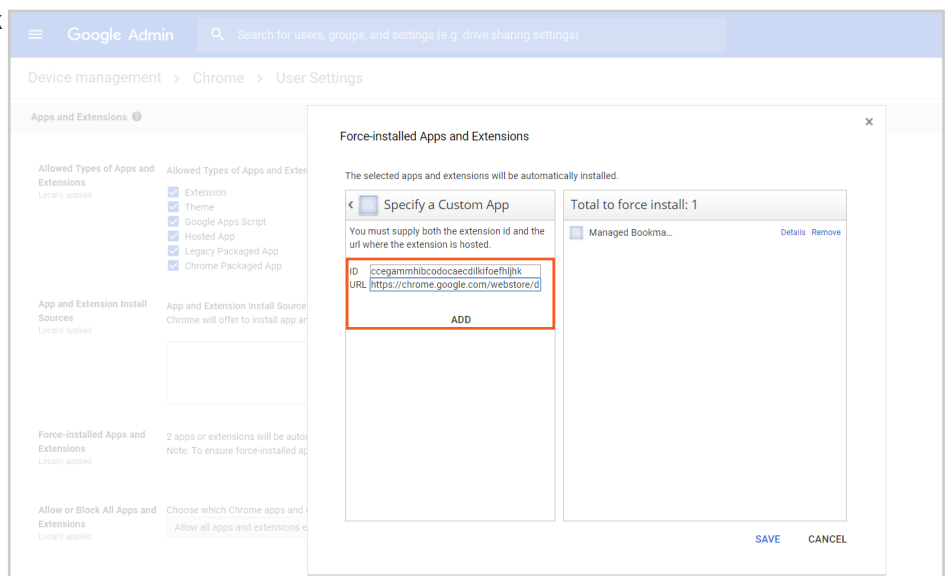

**STEP EIGHT:** Select **ADD** to see the Opposing Viewpoints icon then click **SAVE**

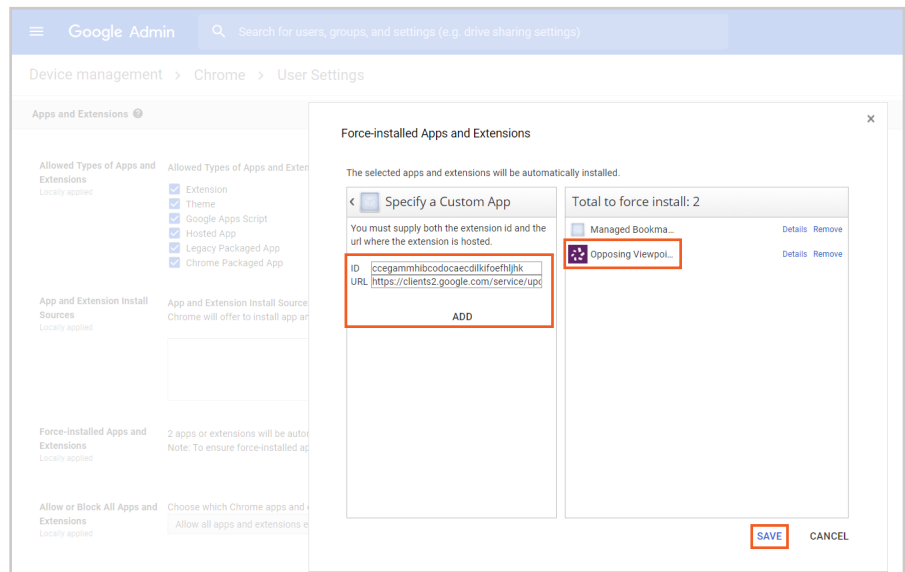

### SETUP THE CONFIGURATION POLICY

**STEP TEN:** Create and upload a configuration policy .txt file

**STEP ELEVEN:** Location name = the name that will appear at the top of the Chrome Extension

**STEP TWELVE:** Location ID and Password to access your library's database.

Example of .txt configuration file for Chrome OS:

```
{
  "locationName": {
    "Value": "My Favorite Library"
  },
  "locationId": {
    "Value": "mylibraryid"
  },
  "locationPassword": {
    "Value": "password123"
  }
}
```

For Linux users, use the policy configuration by placing the following file in `/etc/opt/chrome/policies/managed/policies.json`:

```
{
  "3rdparty": {
    "extensions": {
      "mffhlnigelmkecfpamhikkebonakoi": {
        "locationName": "Pangea Policy 2/8/2017"
      }
    }
  }
}
```

Additional information on policy files: <https://www.chromium.org/administrators/configuring-policy-for-extensions>

**STEP THIRTEEN:** Select **Device Management**

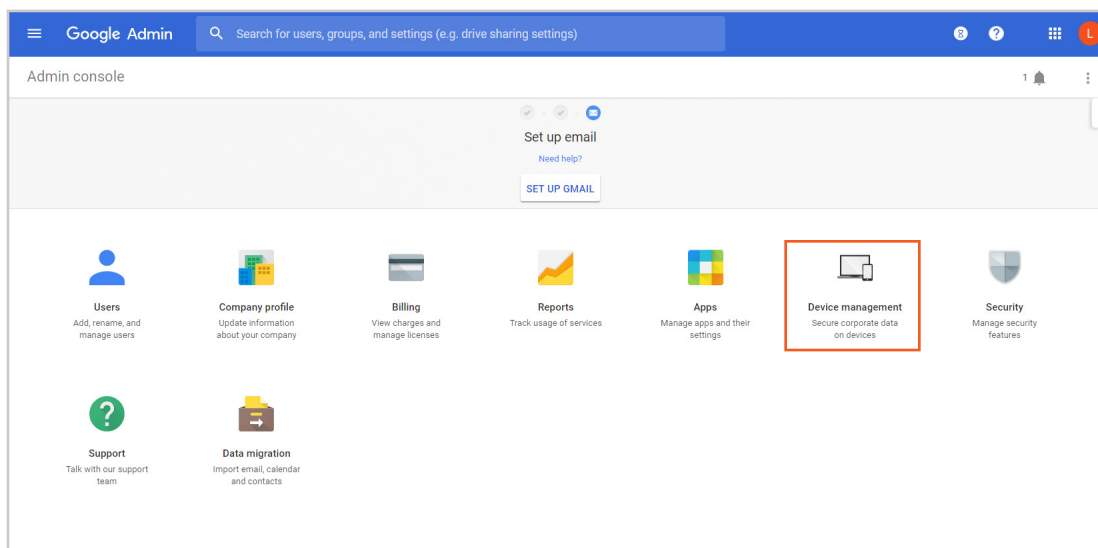

**STEP FOURTEEN:** Select **Chrome Management**

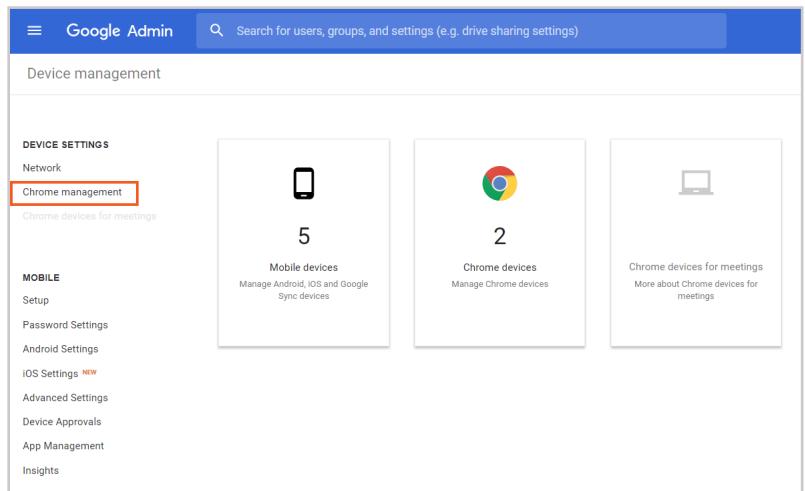

**STEP FIFTEEN:** Select **App Management**

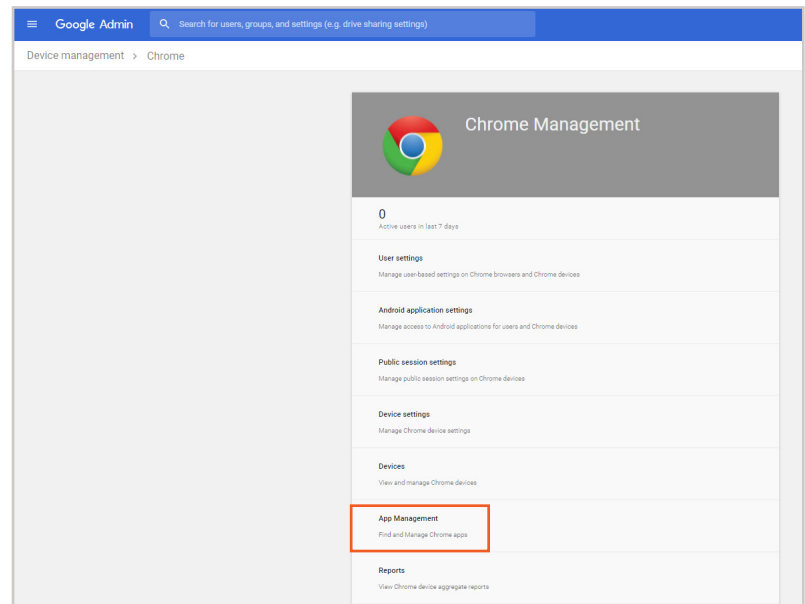

**STEP SIXTEEN:** Select extension *Opposing Viewpoints In Context (Beta)*

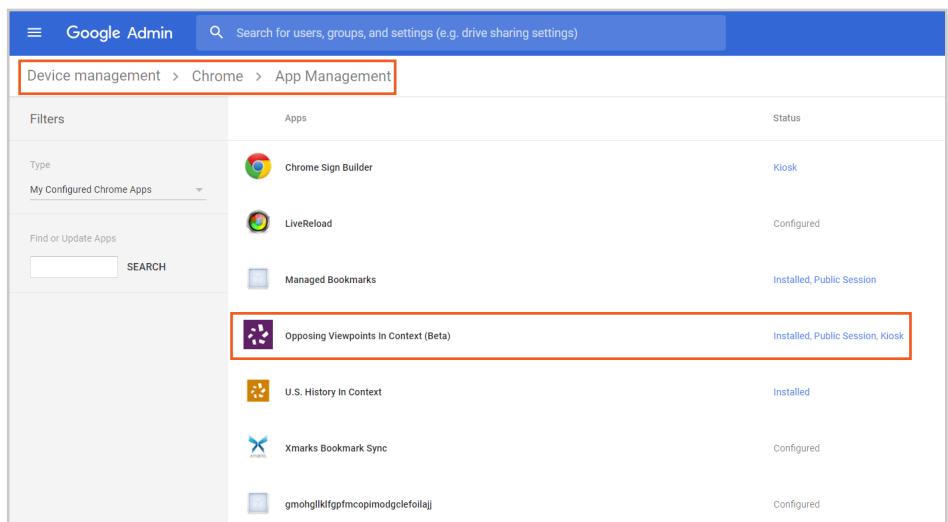

**STEP SEVENTEEN:** Select **User settings**

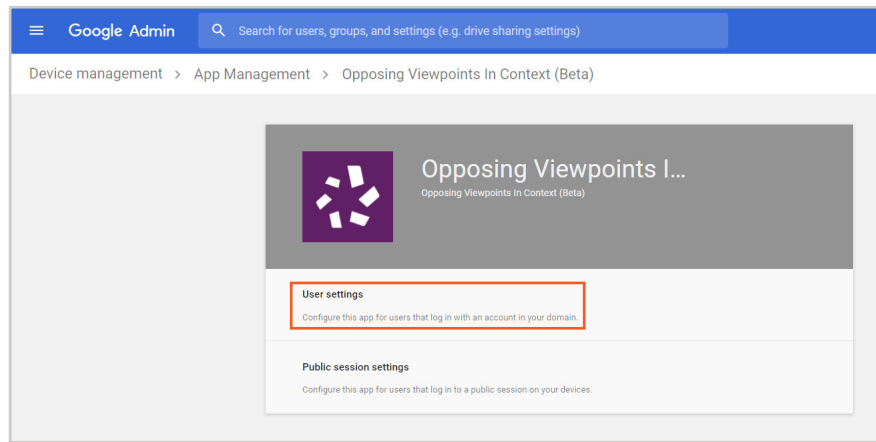

**STEP EIGHTEEN:** Under Orgs, select your organization name

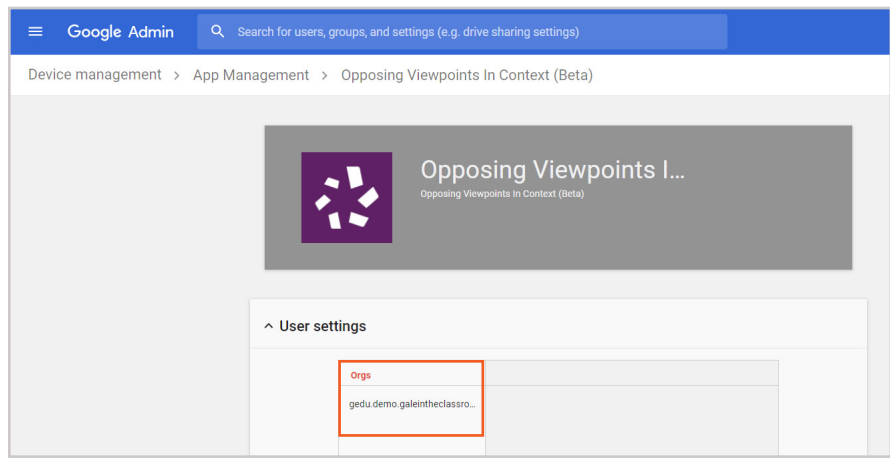

**STEP NINETEEN:** Upload Configuration File and Select **Save**

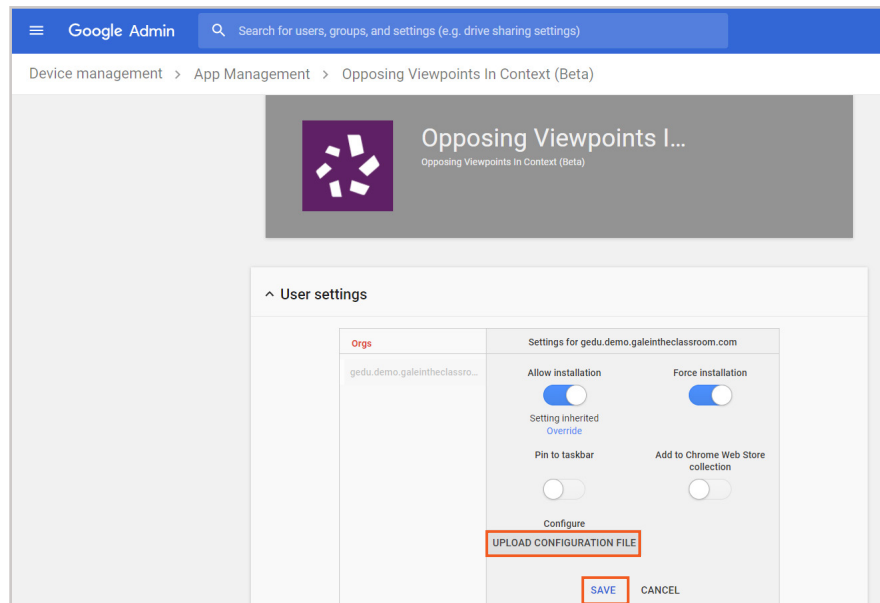

Managed extension changes may take up to 24-48 hours to appear on shared devices.

For questions contact: [GaleAppsForEducation@cengage.com](mailto:GaleAppsForEducation@cengage.com)

**LEARN MORE**

If you require further assistance with *[Opposing Viewpoints In Context](#)* please ask your librarian or visit [gale.com/training](http://gale.com/training).

